

# HOMER TOWNSHIP SECTION 19 R13 TWP 7 MORGAN COUNTY, OH

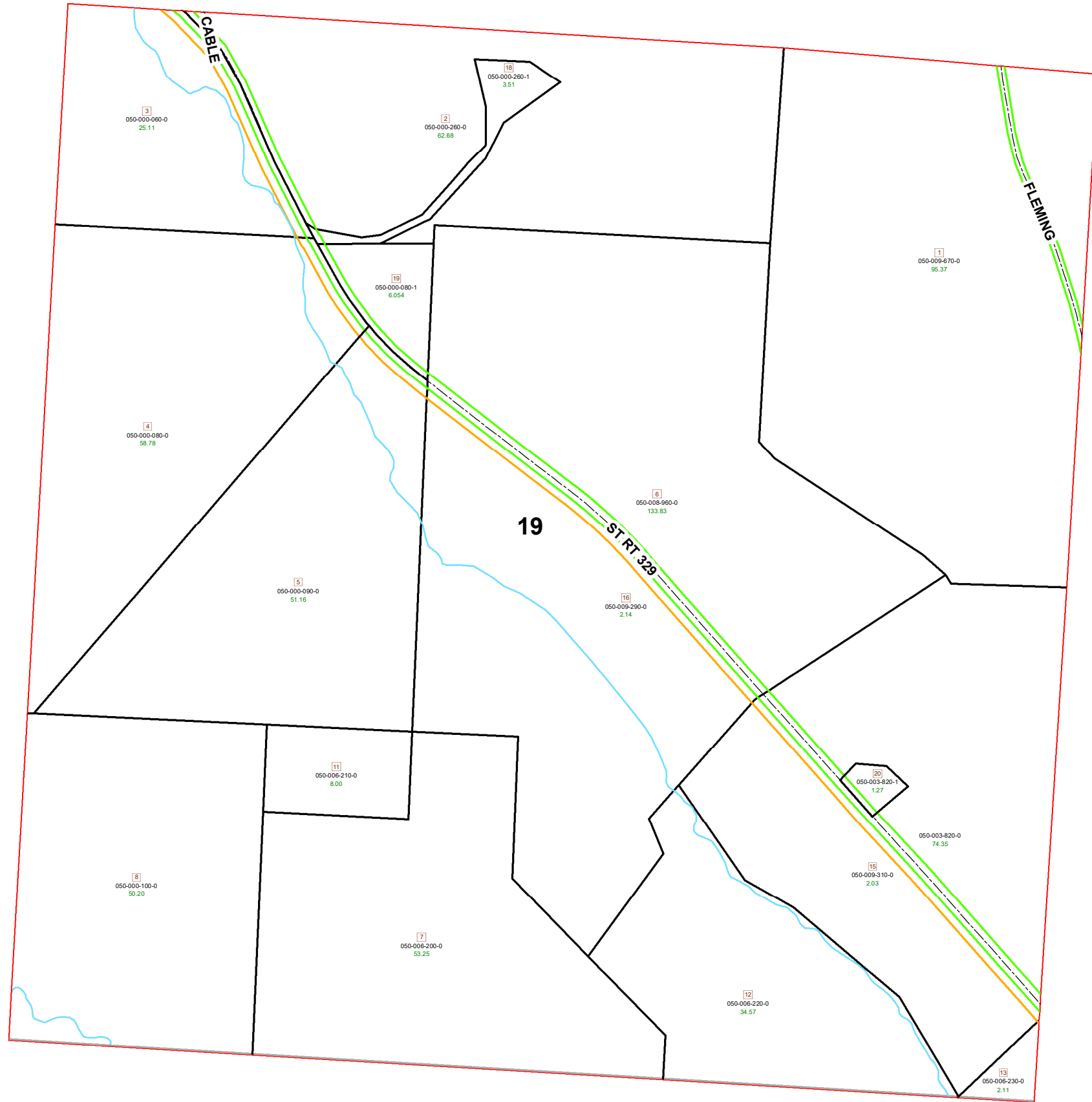

PIN	VOL	PAGE	Owner	LegalDescr	Acre
050-000-100-0	OR234	546	CARTWRIGHT PATSY L ETAL	R13 T07 S19 SD 08	50.2
050-009-310-0	D.V 42	239	EAST CENTRAL OHIO REALTY	R13 T07 S19 RIGHT OF WA	2.03
050-009-290-0	OR233	1534	HOCHSTETLER JERRY & RHODA	R13 T07 S19 RIGHT OF WA	2.14
050-008-960-0	OR233	1534	HOCHSTETLER JERRY & RHODA	R13 T07 S19 SD 6 SURVI	133.8
050-000-260-1	OR135	145	LEHMAN ROGER R & SANDRA S	R13 T07 S19 SD 18 SURVI	3.518
050-000-260-0	D.V 11	208	LEHMAN ROGER R & SANDRA S	R13 T07 S19 SD 02 EX CO	62.68
050-006-230-0	OR233	5323	MEHRI FAMILY SPRAY TRUST	R13 T07 S19 SD 13	2.11
050-006-220-0	OR233	5323	MEHRI FAMILY SPRAY TRUST	R13 T07 S19 SD 12	34.57
050-006-200-0	OR233	5323	MEHRI FAMILY SPRAY TRUST	R13 T07 S19 SD 7	53.25
050-006-210-0	OR233	5323	MEHRI FAMILY SPRAY TRUST	R13 T07 S19 SD 11	8
050-000-080-0	OR233	1502	MILLER MARK & LEANNA	R13 T07 S19 SD 04 SURVI	58.78
050-000-090-0	OR233	1502	MILLER MARK & LEANNA	R13 T07 S19 SD 05 SURVI	51.16
050-003-820-1	OR196	461	STANLEY WILLARD R JR	R13 T07 S19 SD 20 EX CO	1.274
050-003-820-0	OR196	461	STANLEY WILLARD R JR	R13 T07 S19 SD 10 EX CO	74.35
050-000-080-1	OR232	4184	T.Y. RENTALS, LLC	R13 T07 S19 SD 19	6.054
050-000-060-0	OR233	3804	TROYER JON M & JUANITA L	R13 T07 S19 SD 03 SURVI	25.11
050-009-670-0	OR220	1362	WAGNER KEVIN S & KELLEEN	R13 T07 S19 SD 1 EX COA	95.37

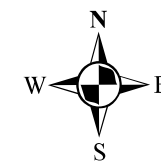

Boundaries	
-----	Hidden
-----	ROW
-----	Section
-----	Township
-----	Parcels
-----	County
-----	Parcel
-----	Lot
-----	Hydro

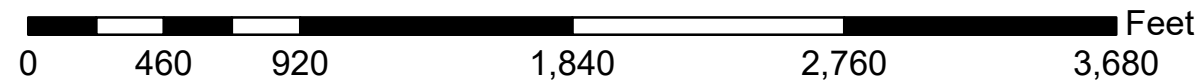

Disclaimer: The information that these maps contains is for reference purposes only. Please bring any errors to the attention of the Engineer's Office staff.  
Thank you